

4

FERRAGENS  
PARA MOBILIÁRIO  
**FURNITURE  
HARDWARE**  
HERRAJES  
PARA MUEBLE.

4.1  
**PUXADOR DE MÓVEL /**  
FURNITURE KNOB /  
POMO DE MUEBLE.

4.2  
**CONCHA DE EMBUTIR /**  
CONCEALED FLUSH HANDLE /  
CAZOLETA DE EMBUTIR.

4.3  
**ASA DE MÓVEL /**  
FURNITURE HANDLE /  
TIRADOR DE MUEBLE.

4.4  
**CHROMIUM FREE**  
SERIES





## Two lines Knob

ø10 x 22mm

IN.22.107.10 / Un.

*Puxador de móvel, com parafuso M4 para instalação |  
Furniture knob with M4 screw for installation |  
Pomo de mueble con tornillo M4 para instalación.  
EN 1.4301 - AISI 304 Satinado | Satin*

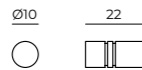

## Two lines Knob

ø14 x 22mm

IN.22.107.14 / Un.

*Puxador de móvel, com parafuso M4 para instalação |  
Furniture knob with M4 screw for installation |  
Pomo de mueble con tornillo M4 para instalación.  
EN 1.4301 - AISI 304 Satinado | Satin*



## Finger Knob

ø10 x 20mm

IN.22.102.10 / Un.

*Puxador de móvel, com parafuso M4 para instalação |  
Furniture knob with M4 screw for installation |  
Pomo de mueble con tornillo M4 para instalación.  
EN 1.4301 - AISI 304 Satinado | Satin*



## Finger Knob

ø14 x 20mm

IN.22.102.14 / Un.

*Puxador de móvel, com parafuso M4 para instalação |  
Furniture knob with M4 screw for installation |  
Pomo de mueble con tornillo M4 para instalación.  
EN 1.4301 - AISI 304 Satinado | Satin*

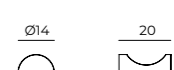

## Pin Knob

ø15 x 20mm

IN.22.108.15 / Un.

*Puxador de móvel, com parafuso M4 para instalação |  
Furniture knob with M4 screw for installation |  
Pomo de mueble con tornillo M4 para instalación.  
EN 1.4301 - AISI 304 Satinado | Satin*

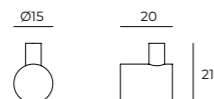

## Pin Knob

ø19 x 25mm

IN.22.108.19 / Un.

*Puxador de móvel, com parafuso M4 para instalação |  
Furniture knob with M4 screw for installation |  
Pomo de mueble con tornillo M4 para instalación.  
EN 1.4301 - AISI 304 Satinado | Satin*

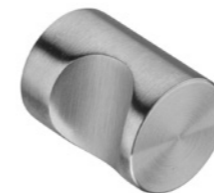
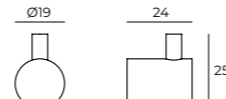

## Finger Knob

ø19 x 25mm

IN.22.102.19 / Un.

*Puxador de móvel, com parafuso M4 para instalação |  
Furniture knob with M4 screw for installation |  
Pomo de mueble con tornillo M4 para instalación.  
EN 1.4301 - AISI 304 Satinado | Satin*



## Finger Knob

ø25 x 28mm

IN.22.102.25 / Un.

*Puxador de móvel, com parafuso M4 para instalação |  
Furniture knob with M4 screw for installation |  
Pomo de mueble con tornillo M4 para instalación.  
EN 1.4301 - AISI 304 Satinado | Satin*



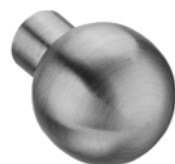

## Orb knob

Ø15 x 20mm

IN.22.111.15 / Un.

Puxador de móvel, com parafuso M4 para instalação |  
Furniture knob with M4 screw for installation |  
Pomo de mueble con tornillo M4 para instalación.  
EN 1.4301 - AISI 304 Satinado | Satin

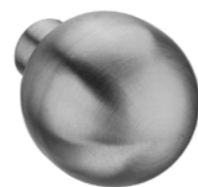

## Orb knob

Ø20 x 25mm

IN.22.111.20 / Un.

Puxador de móvel, com parafuso M4 para instalação |  
Furniture knob with M4 screw for installation |  
Pomo de mueble con tornillo M4 para instalación.  
EN 1.4301 - AISI 304 Satinado | Satin



## Oblong Knob

h26 x cc32

IN.22.211.26 / Un.

Puxador de móvel, com parafuso M4 para instalação |  
Furniture knob with M4 screw for installation |  
Pomo de mueble con tornillo M4 para instalación.  
EN 1.4301 - AISI 304 Satinado | Satin

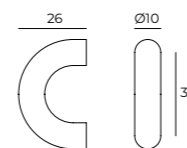

## Oblong Knob

h40 x cc32

IN.22.211.40 / Un.

Puxador de móvel, com parafuso M4 para instalação |  
Furniture knob with M4 screw for installation |  
Pomo de mueble con tornillo M4 para instalación.  
EN 1.4301 - AISI 304 Satinado | Satin

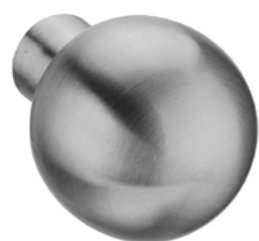

## Orb knob

Ø25 x 33mm

IN.22.111.25 / Un.

Puxador de móvel, com parafuso M4 para instalação |  
Furniture knob with M4 screw for installation |  
Pomo de mueble con tornillo M4 para instalación.  
EN 1.4301 - AISI 304 Satinado | Satin

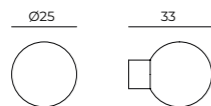

## Orb knob

Ø30 x 35mm

IN.22.111.30 / Un.

Puxador de móvel, com parafuso M4 para instalação |  
Furniture knob with M4 screw for installation |  
Pomo de mueble con tornillo M4 para instalación.  
EN 1.4301 - AISI 304 Satinado | Satin

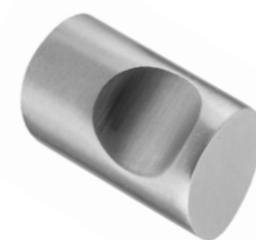
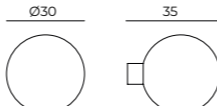

## Ergo form Knob

24 / 21 x 34mm

IN.22.124 / Un.

Puxador de móvel, com parafuso M4 para instalação |  
Furniture knob with M4 screw for installation |  
Pomo de mueble con tornillo M4 para instalación.  
EN 1.4301 - AISI 304 Satinado | Satin

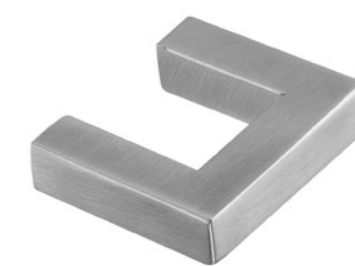
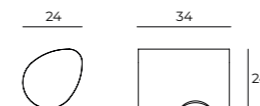

## Quadro series 10x10

h35 x cc32

IN.22.200.10.032 / Un.

Puxador de móvel, com parafuso M4 para instalação |  
Furniture knob with M4 screw for installation |  
Pomo de mueble con tornillo M4 para instalación.  
EN 1.4301 - AISI 304 Satinado | Satin

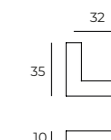





## Nautic handle

44x38mm

IN.16.108 / Un.

Concha de embutir com mola /  
Concealed flush handle with spring /  
Cazoleta de embutir con muelle.  
EN 1.4301 - AISI 304 Satinado | Satin

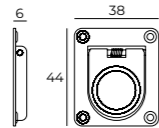

## Nautic handle

Ø55mm

IN.16.107 / Un.

Concha de embutir com mola /  
Concealed flush handle with spring /  
Cazoleta de embutir con muelle.  
EN 1.4301 - AISI 304 Satinado | Satin

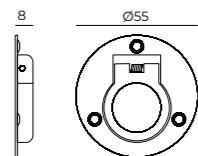

## Nautic handle

65x55mm

IN.16.109 / Un.

Concha de embutir com mola /  
Concealed flush handle with spring /  
Cazoleta de embutir con muelle.  
EN 1.4301 - AISI 304 Satinado | Satin

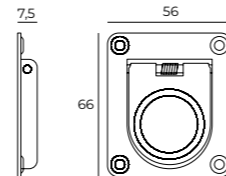

## Nautic handle

58x75mm

IN.16.110 / Un.

Concha de embutir com mola /  
Concealed flush handle with spring /  
Cazoleta de embutir con muelle.  
EN 1.4301 - AISI 304 Satinado | Satin

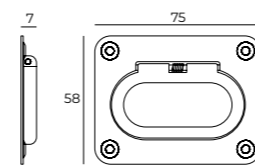

Ø8

## Tubular Ø8

Furniture handles

IN.22.202.08.064 / Un.  
IN.22.202.08.096 / Un.  
IN.22.202.08.128 / Un.  
IN.22.202.08.160 / Un.  
IN.22.202.08.224 / Un.

Asa de móvel, com parafusos M4 para instalação |  
Furniture handle with M4 screws for installation |  
Tirador de mueble con tornillos M4 para instalación.  
EN 1.4301 - AISI 304 Satinado | Satin

C.C.	L	5 Un.	50 Un.	Ø8	35
64	72	25	250		
96	104	25	250		
128	136	25	250		
160	168	25	250		
224	232	25	150		



Ø10

## Tubular Ø10

Furniture handles

IN.22.202.10.096 / Un.  
IN.22.202.10.128 / Un.  
IN.22.202.10.224 / Un.  
IN.22.202.10.320 / Un.  
IN.22.202.10.512 / Un.

Asa de móvel, com parafusos M4 para instalação |  
Furniture handle with M4 screws for installation |  
Tirador de mueble con tornillos M4 para instalación.  
EN 1.4301 - AISI 304 Satinado | Satin

C.C.	L	H	5 Un.	50 Un.	Ø10	H
96	106	35	25	250		
128	138	35	25	150		
224	234	35	12	120		
320	330	35	12	120		
512	522	40	12	120		



Ø12

## Intersection Ø12 Furniture handles

IN.22.209.12.096 / Un.  
IN.22.209.12.128 / Un.  
IN.22.209.12.160 / Un.  
IN.22.209.12.192 / Un.  
IN.22.209.12.224 / Un.  
IN.22.209.12.288 / Un.  
IN.22.209.12.320 / Un.

Asa de móvel, com parafusos M4 para instalação |  
Furniture handle with M4 screws for installation |  
Tirador de mueble con tornillos M4 para instalación.  
EN 1.4301 - AISI 304 Satinado | Satin

C.C.	L	⬢	⬢
96	156	12	120
128	188	12	120
160	220	12	120
192	252	12	120
224	284	12	120
288	348	12	72
320	380	12	72



Ø12

## Intersection Ø12 Furniture handles

IN.22.209.12.736 / Un.  
IN.22.209.12.832 / Un.  
IN.22.209.12.896 / Un.  
IN.22.209.12.960 / Un.  
IN.22.209.12.1184 / Un.  
IN.22.209.12.1376 / Un.

Asa de móvel, com parafusos M4 para instalação |  
Furniture handle with M4 screws for installation |  
Tirador de mueble con tornillos M4 para instalación.  
EN 1.4301 - AISI 304 Satinado | Satin

C.C.	L	⬢	⬢
736	796	6	36
832	892	6	36
896	956	6	36
960	1020	6	36
1184	1244	6	36
1376	1436	6	36



Ø12

## Intersection Ø12 Furniture handles

IN.22.209.12.352 / Un.  
IN.22.209.12.384 / Un.  
IN.22.209.12.448 / Un.  
IN.22.209.12.480 / Un.  
IN.22.209.12.544 / Un.  
IN.22.209.12.640 / Un.  
IN.22.209.12.704 / Un.

Asa de móvel, com parafusos M4 para instalação |  
Furniture handle with M4 screws for installation |  
Tirador de mueble con tornillos M4 para instalación.  
EN 1.4301 - AISI 304 Satinado | Satin

C.C.	L	⬢	⬢
352	412	12	72
384	444	12	72
448	508	12	72
480	540	12	72
544	604	12	48
640	700	12	48
704	744	12	48



Ø10

## T-eco handle Ø10 Furniture handles

IN.22.209.10.096.ECO / Un.  
IN.22.209.10.128.ECO / Un.  
IN.22.209.10.160.ECO / Un.  
IN.22.209.10.192.ECO / Un.  
IN.22.209.10.224.ECO / Un.  
IN.22.209.10.320.ECO / Un.

Asa de móvel, com parafusos M4 para instalação |  
Furniture handle with M4 screws for installation |  
Tirador de mueble con tornillos M4 para instalación.  
EN 1.4372 - AISI 201 Satinado | Satin

C.C.	L	⬢	⬢
96	136	12	120
128	168	12	120
160	200	12	120
192	232	12	120
224	264	12	120
320	360	12	72



Ø8

Ø12

## Blend Ø8 / Ø12

Furniture handles

IN.22.212.096 / Un.  
IN.22.212.128 / Un.

Asa de móvel, com parafusos M4 para instalação |  
Furniture handle with M4 screws for installation |  
Tirador de mueble con tornillos M4 para instalación.  
EN 1.4301 - AISI 304 Satinado | Satin

C.C.	L	Ø8	Ø12
96	110	12	120
128	145	12	120



Ø10

## Boomerang Ø10

Furniture handles

IN.22.210.096 / Un.  
IN.22.210.128 / Un.  
IN.22.210.160 / Un.

Asa de móvel, com parafusos M4 para instalação |  
Furniture handle with M4 screws for installation |  
Tirador de mueble con tornillos M4 para instalación.  
EN 1.4301 - AISI 304 Satinado | Satin

C.C.	L	Ø10	30
96	130	25	250
128	160	20	200
160	180	20	200



Ø10

## Arch Ø10

Furniture handles

IN.22.201.096 / Un.  
IN.22.201.128 / Un.  
IN.22.201.224 / Un.  
IN.22.201.320 / Un.

Asa de móvel, com parafusos M4 para instalação |  
Furniture handle with M4 screws for installation |  
Tirador de mueble con tornillos M4 para instalación.  
EN 1.4301 - AISI 304 Satinado | Satin

C.C.	L	Ø10	30
96	110	25	250
128	150	25	250
224	260	10	120
320	370	10	120



Ø10

## Tear drop Ø10

Furniture handles

IN.22.215 / Un.

Asa de móvel, com parafusos M4 para instalação |  
Furniture handle with M4 screws for installation |  
Tirador de mueble con tornillos M4 para instalación.  
EN 1.4301 - AISI 304 Satinado | Satin

C.C.	L	Ø10	30
140	128		

25 Un. 250 Un.



Ø10

## Angulo Ø10

Furniture handles

IN.22.204.10.096 / Un.  
IN.22.204.10.128 / Un.  
IN.22.204.10.224 / Un.  
IN.22.204.10.320 / Un.

Asa de móvel, com parafusos M4 para instalação |  
Furniture handle with M4 screws for installation |  
Tirador de mueble con tornillos M4 para instalación.  
EN 1.4301 - AISI 304 Satinado | Satin

C.C.	L	⬇	⬆
96	106	25	250
128	138	25	250
224	234	12	120
320	330	12	120



Ø16

## Union Ø16

Furniture handles

IN.22.820.128 / Un.  
IN.22.820.160 / Un.  
IN.22.820.192 / Un.  
IN.22.820.224 / Un.  
IN.22.820.320 / Un.

Asa de móvel, com parafusos M4 para instalação |  
Furniture handle with M4 screws for installation |  
Tirador de mueble con tornillos M4 para instalación.  
EN 1.4301 - AISI 304 Satinado | Satin

C.C.	L	⬇	⬆
128	152	12	120
160	184	12	120
192	216	12	120
224	248	12	120
320	344	12	120



Ø16

## Angulo Ø16

Furniture handles

IN.22.204.16.224 / Un.  
IN.22.204.16.320 / Un.  
IN.22.204.16.384 / Un.  
IN.22.204.16.448 / Un.

Asa de móvel, com parafusos M4 para instalação |  
Furniture handle with M4 screws for installation |  
Tirador de mueble con tornillos M4 para instalación.  
EN 1.4301 - AISI 304 Satinado | Satin

C.C.	L	⬇	⬆
224	240	6	60
320	336	6	60
384	400	6	60
448	464	6	60



Ø16

## Union Ø16

Furniture handles

IN.22.820.400 / Un.  
IN.22.820.448 / Un.  
IN.22.820.592 / Un.  
IN.22.820.688 / Un.  
IN.22.820.800 / Un.

Asa de móvel, com parafusos M4 para instalação |  
Furniture handle with M4 screws for installation |  
Tirador de mueble con tornillos M4 para instalación.  
EN 1.4301 - AISI 304 Satinado | Satin

C.C.	L	⬇	⬆
400	424	6	60
448	472	6	60
592	616	6	60
688	712	6	60
800	824	6	60



8x8

## Quadro series 8x8

Furniture handles

IN.22.200.08.096 / Un.  
IN.22.200.08.128 / Un.  
IN.22.200.08.160 / Un.  
IN.22.200.08.192 / Un.  
IN.22.200.08.224 / Un.  
Asa de móvel, com parafusos M4 para instalação |  
Furniture handle with M4 screws for installation |  
Tirador de mueble con tornillos M4 para instalación.  
EN 1.4301 - AISI 304 Satinado | Satin

C.C.	L	8	35
96	104	12	120
128	136	12	120
160	168	12	96
192	200	12	96
224	232	12	96



10x10

## Quadro series 10x10

Furniture handles

IN.22.200.10.096 / Un.  
IN.22.200.10.128 / Un.  
IN.22.200.10.160 / Un.  
IN.22.200.10.224 / Un.  
IN.22.200.10.320 / Un.  
Asa de móvel, com parafusos M4 para instalação |  
Furniture handle with M4 screws for installation |  
Tirador de mueble con tornillos M4 para instalación.  
EN 1.4301 - AISI 304 Satinado | Satin

C.C.	L	10	35
96	106	12	120
128	138	12	96
160	170	12	96
224	234	12	96
320	330	12	96



12x12

## Quadro series 12x12

Furniture handles

IN.22.200.12.128 / Un.  
IN.22.200.12.160 / Un.  
IN.22.200.12.224 / Un.  
IN.22.200.12.320 / Un.  
IN.22.200.12.480 / Un.  
IN.22.200.12.704 / Un.  
Asa de móvel, com parafusos M4 para instalação |  
Furniture handle with M4 screws for installation |  
Tirador de mueble con tornillos M4 para instalación.  
EN 1.4301 - AISI 304 Satinado | Satin

C.C.	L	12	35
128	140	12	120
160	172	12	96
224	236	12	96
320	332	12	96
480	492	12	96
704	716	12	72



16x16

## Quadro series 16x16

Furniture handles

IN.22.200.16.224 / Un.  
IN.22.200.16.384 / Un.  
IN.22.200.16.480 / Un.  
IN.22.200.16.704 / Un.  
Asa de móvel, com parafusos M4 para instalação |  
Furniture handle with M4 screws for installation |  
Tirador de mueble con tornillos M4 para instalación.  
EN 1.4301 - AISI 304 Satinado | Satin

C.C.	L	16	40
224	240	6	60
384	400	6	60
488	496	6	60
704	720	6	60





## Linear 10x20

Furniture handles

IN.22.230.160 / Un.  
IN.22.230.192 / Un.  
IN.22.230.224 / Un.  
IN.22.230.320 / Un.

Asa de móvel, com parafusos M4 para instalação |  
Furniture handle with M4 screws for installation |  
Tirador de mueble con tornillos M4 para instalación.  
EN 1.4301 - AISI 304 Satinado | Satin

C.C.	L		
160	170	10	100
192	202	10	100
224	234	10	100
320	330	10	50



## Square 22x22

Furniture handles

IN.22.318.288 / Un.  
IN.22.318.384 / Un.

Asa de móvel, com parafusos M4 para instalação |  
Furniture handle with M4 screws for installation |  
Tirador de mueble con tornillos M4 para instalación.  
EN 1.4301 - AISI 304 Satinado | Satin

C.C.	L		
288	310	6	60
384	406	6	60

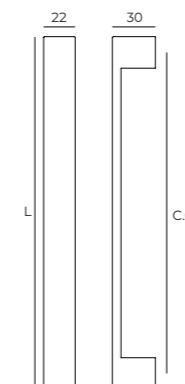

## Linear 10x20

Furniture handles

IN.22.230.384 / Un.  
IN.22.230.608 / Un.  
IN.22.230.800 / Un.

Asa de móvel, com parafusos M4 para instalação |  
Furniture handle with M4 screws for installation |  
Tirador de mueble con tornillos M4 para instalación.  
EN 1.4301 - AISI 304 Satinado | Satin

C.C.	L		
384	394	10	50
608	618	10	50
800	810	10	50

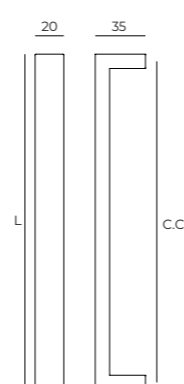

## Rectangular 20x10

Furniture handles

IN.22.224.160 / Un.  
IN.22.224.224 / Un.  
IN.22.224.320 / Un.  
IN.22.224.488 / Un.  
IN.22.224.704 / Un.

Asa de móvel, com parafusos M4 para instalação |  
Furniture handle with M4 screws for installation |  
Tirador de mueble con tornillos M4 para instalación.  
EN 1.4301 - AISI 304 Satinado | Satin

C.C.	L		
160	176	12	96
224	240	12	96
320	400	12	96
488	496	12	48
704	720	12	24

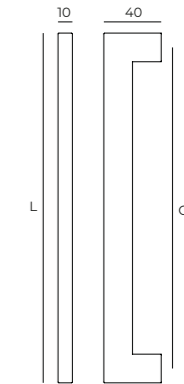





## Flat 20x6

Furniture handles

IN.22.218.128 / Un.  
IN.22.218.160 / Un.

Asa de móvel, com parafusos M4 para instalação |  
Furniture handle with M4 screws for installation |  
Tirador de mueble con tornillos M4 para instalación.  
EN 1.4301 - AISI 304 Satinado | Satin

C.C.	L		
128	134	12	120
160	166	12	120

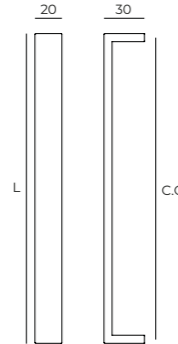





## Off-site 10x10

Furniture handles

IN.22.208.192 / Un.  
IN.22.208.224 / Un.  
IN.22.208.320 / Un.  
IN.22.208.512 / Un.

Asa de móvel, com parafusos M4 para instalação |  
Furniture handle with M4 screws for installation |  
Tirador de mueble con tornillos M4 para instalación.  
EN 1.4301 - AISI 304 Satinado | Satin

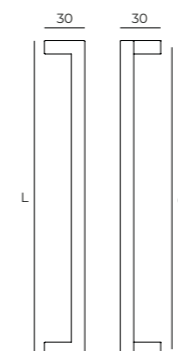
C.C.	L		
192	202	6	72
224	234	6	72
320	330	6	72
512	522	6	72







## Arch spindle 10x10

Furniture handles

IN.22.214.128 / Un.  
IN.22.214.160 / Un.  
IN.22.214.224 / Un.  
IN.22.214.320 / Un.

Asa de móvel, com parafusos M4 para instalação |  
Furniture handle with M4 screws for installation |  
Tirador de mueble con tornillos M4 para instalación.  
EN 1.4301 - AISI 304 Satinado | Satin

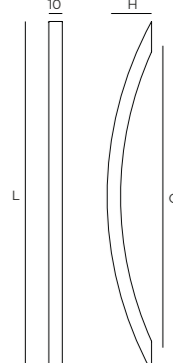
C.C.	L	H		
128	152	30	12	120
160	188	30	12	120
224	261	33	12	120
320	370	38	6	72



**CHROMIUM  
FREE**



## Tic-Tac Square Retractable knob

IN.22.190 / Un.

*Puxador de móvel retráctil (tic-tac) /  
Retractable furniture knob (tic-tac) /  
Tirador retráctil para mueble (tic-tac).*

RAL 9006 (cinzento / grey / gris)

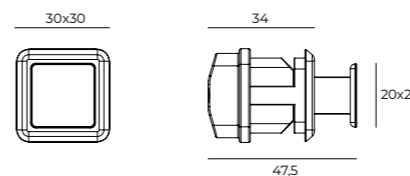

4 Un. 48 Un



## Tic-Tac Rounded Retractable knob

IN.22.191 / Un.

*Puxador de móvel retráctil (tic-tac) /  
Retractable furniture knob (tic-tac) /  
Tirador retráctil para mueble (tic-tac).*

RAL 9006 (cinzento / grey / gris)

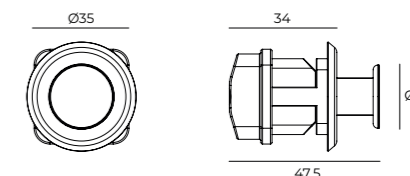

4 Un. 48 Un



## T handle Rounded $\varnothing 12$ Furniture handles

**22750.128** / Un.

*Asa de móvel, com parafusos M4 para instalação |  
Furniture handle with M4 screws for installation |  
Tirador de mueble con tornillos M4 para instalación.*

RAL 9006 (cinzento / grey / gris)

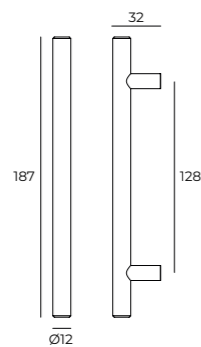

## T Handle Square 12x12 Furniture handles

**4599.AL.128** / Un.

**4599.AL.160** / Un

**4599.AL.288** / Un

*Asa de móvel, com parafusos M4 para instalação |  
Furniture handle with M4 screws for installation |  
Tirador de mueble con tornillos M4 para instalación.*

RAL 9006 (cinzento / grey / gris)

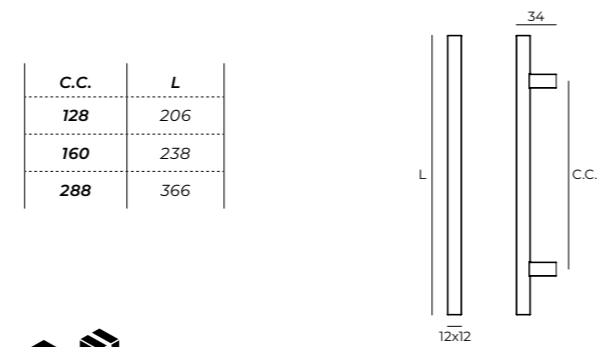

12 Un. 120 Un



## Square 28x24 Furniture handles

**02906.128** / Un.

*Asa de móvel, com parafusos M4 para instalação |  
Furniture handle with M4 screws for installation |  
Tirador de mueble con tornillos M4 para instalación.*

RAL 9006 (cinzento / grey / gris)

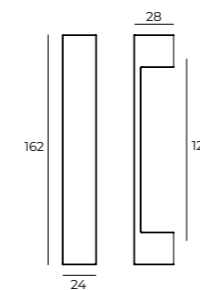

12 Un. 120 Un



## Solid Furniture handles

**23258.032** / Un.

**23258.064** / Un.

*Asa de móvel, com parafusos M4 para instalação |  
Furniture handle with M4 screws for installation |  
Tirador de mueble con tornillos M4 para instalación.*

RAL 9006 (cinzento / grey / gris)

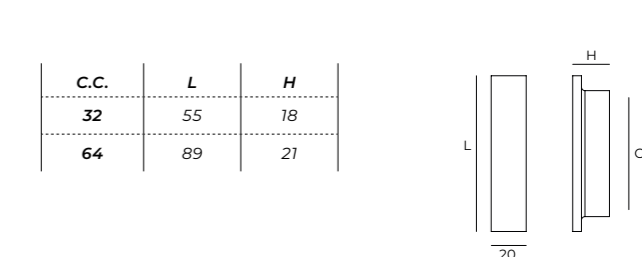

12 Un. 120 Un





## Oval flush handle

invisible fixing screws

23519.128 / Un.

Concha de embutir, com parafusos M4 para instalação /  
Concealed flush handle with M4 screws for installation /  
Cazoleta de embutir con tornillos M4 para instalación.

RAL 9006 (cinzento / grey / gris)

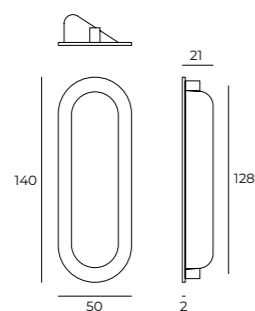

12 Un. 120 Un



## Rounded flush handle

invisible fixing screws

23518.038 / Un.

Concha de embutir, com parafusos M4 para instalação /  
Concealed flush handle with M4 screws for installation /  
Cazoleta de embutir con tornillos M4 para instalación.

RAL 9006 (cinzento / grey / gris)

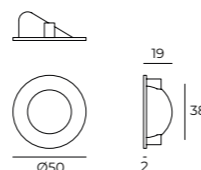

12 Un. 120 Un



## T handle Rounded ø12

Furniture handles

22750.128.B / Un.

Asa de móvel, com parafusos M4 para instalação /  
Furniture handle with M4 screws for installation /  
Tirador de mueble con tornillos M4 para instalación.

RAL 9005 (preto / black / negro)

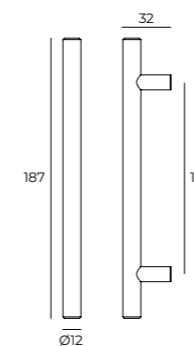

12 Un. 120 Un



## T Handle Square 12x12

Furniture handles

4599.AL.128.B / Un.

4599.AL.160.B / Un

4599.AL.288.B / Un

Asa de móvel, com parafusos M4 para instalação /  
Furniture handle with M4 screws for installation /  
Tirador de mueble con tornillos M4 para instalación.

RAL 9005 (preto / black / negro)

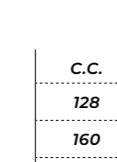

C.C.	L
128	206
160	238
288	366

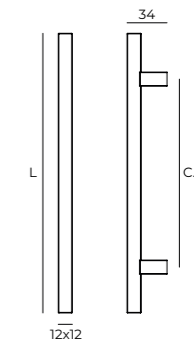

12 Un. 120 Un



## Square 28x24

Furniture handles

**02906.128.B** / Un.

Asa de móvel, com parafusos M4 para instalação |  
Furniture handle with M4 screws for installation |  
Tirador de mueble con tornillos M4 para instalación.

RAL 9005 (preto / black / negro)

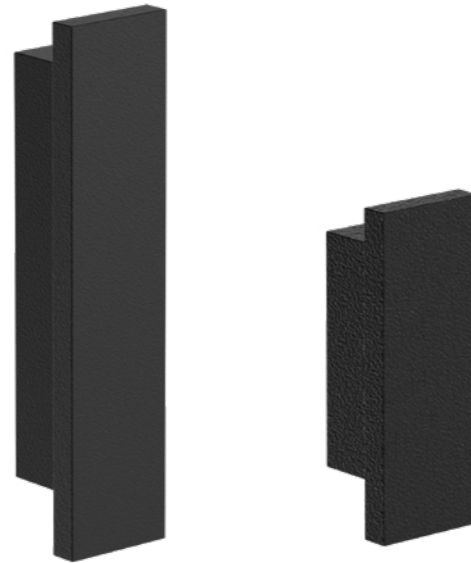
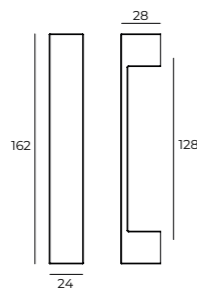

## Solid

Furniture handles

**23258.032.B** / Un.  
**23258.064.B** / Un.

Asa de móvel, com parafusos M4 para instalação |  
Furniture handle with M4 screws for installation |  
Tirador de mueble con tornillos M4 para instalación.

RAL 9005 (preto / black / negro)

C.C.	L	H
32	55	18
64	89	21

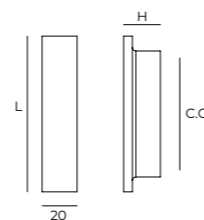

12 Un. 120 Un



## Oval flush handle

invisible fixing screws

**23519.128.B** / Un.

Concha de embutir, com parafusos M4 para instalação |  
Concealed flush handle with M4 screws for installation |  
Cazoleta de embutir con tornillos M4 para instalación.

RAL 9005 (preto / black / negro)

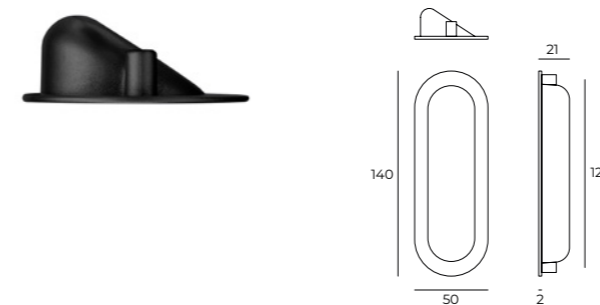

12 Un. 120 Un



## Rounded flush handle

invisible fixing screws

**23518.038.B** / Un.

Concha de embutir, com parafusos M4 para instalação |  
Concealed flush handle with M4 screws for installation |  
Cazoleta de embutir con tornillos M4 para instalación.

RAL 9005 (preto / black / negro)

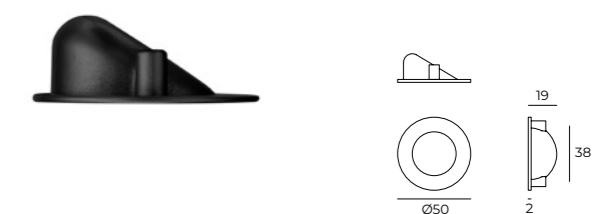

12 Un. 120 Un



## Tic-Tac Square

Retractable knob

**IN.22.190.B** / Un.

*Puxador de móvel retráctil (tic-tac) /  
Retractable furniture knob (tic-tac) /  
Tirador retráctil para mueble (tic-tac).*

RAL 9005 (preto / black / negro)

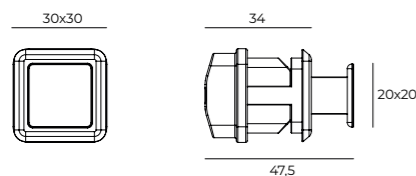

## Tic-Tac Rounded

Retractable knob

**IN.22.191.B** Un.

*Puxador de móvel retráctil (tic-tac) /  
Retractable furniture knob (tic-tac) /  
Tirador retráctil para mueble (tic-tac).*

RAL 9005 (preto / black / negro)

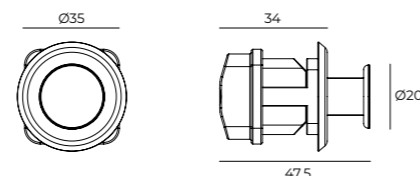

4 Un. 48 Un

